

## BLZP 5.08HC/02/180 SN OR BX

Weidmüller Interfaces GmbH & Co. KG

Postfach 3030

32760 Detmold

Tel. +49 5231 14-0

Fax. +49 5231 14-2083

info@weidmueller.com

www.weidmueller.com

### Product image

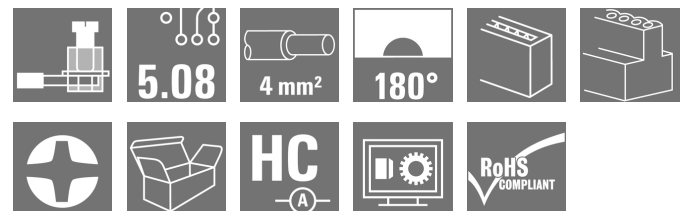

Similar to illustration

Female plug with clamping-yoke screw system for connecting wires with straight (180°) outlet direction. The female connectors provide space for labelling and can be coded. Fastened by means of a flange or release latch. They also provide an integrated plus/minus screw, protection against faulty insertion of the wire, and they are delivered with open clamping yokes. HC = High Current.

### General ordering data

|              |   |
|--------------|---|
| Version      | PCB plug-in connector, female plug, 5.08 mm, Number of poles: 2, 180°, Clamping yoke connection, Clamping range, max.: 4 mm², Box |
| Order No.    | <a href="#">1943580000</a>  |
| Type         | BLZP 5.08HC/02/180 SN OR BX   |
| GTIN (EAN)   | 4032248617562   |
| Qty.         | 180 pc(s).  |
| Product data | IEC: 400 V / 23 A / 0.2 - 4 mm²<br>UL: 300 V / 20 A / AWG 26 - AWG 12   |
| Packaging    | Box   |

Creation date November 23, 2020 8:26:37 AM CET

**BLZP 5.08HC/02/180 SN OR BX**
**Weidmüller Interfaces GmbH & Co. KG**

Postfach 3030

32760 Detmold

Tel. +49 5231 14-0

Fax. +49 5231 14-2083

[info@weidmueller.com](mailto:info@weidmueller.com)
[www.weidmueller.com](http://www.weidmueller.com)
**Technical data**
**Dimensions and weights**

|                |          |                 |            |
|----------------|----------|-----------------|------------|
| Depth          | 20.1 mm  | Depth (inches)  | 0.791 inch |
| Height         | 16 mm    | Height (inches) | 0.63 inch  |
| Net weight     | 3.51 g   | Width           | 10.16 mm   |
| Width (inches) | 0.4 inch |                 |            |

**System Parameters**

|  |  |                   |                            |
|--|--|-------------------|----------------------------|
| Product family                               | OMNIMATE Signal - series BL/SL 5.08    |                   |                            |
| Type of connection                           | Field connection                       |                   |                            |
| Wire connection method                       | Clamping yoke connection               |                   |                            |
| Pitch in mm (P)                              | 5.08 mm                                |                   |                            |
| Pitch in inches (P)                          | 0.2 inch                               |                   |                            |
| Conductor outlet direction                   | 180°                                   |                   |                            |
| Number of poles                              | 2                                      |                   |                            |
| L1 in mm                                     | 5.08 mm                                |                   |                            |
| L1 in inches                                 | 0.2 inch                               |                   |                            |
| Number of rows                               | 1                                      |                   |                            |
| Pin series quantity                          | 1                                      |                   |                            |
| Rated cross-section                          | 4 mm <sup>2</sup>                      |                   |                            |
| Touch-safe protection acc. to DIN VDE 57 106 | Safe from finger touch                 |                   |                            |
| Volume resistance                            | ≤5 mΩ                                  |                   |                            |
| Can be coded                                 | Yes                                    |                   |                            |
| Stripping length                             | 7 mm                                   |                   |                            |
| Clamping screw                               | M 2.5                                  |                   |                            |
| Screwdriver blade                            | 0.6 x 3.5, PH 1, PZ 1                  |                   |                            |
| Screwdriver blade standard                   | DIN 5264, ISO 8764/2-PH, ISO 8764/2-PZ |                   |                            |
| Plugging cycles                              | 25                                     |                   |                            |
| Plugging force/pole, max.                    | 10 N                                   |                   |                            |
| Pulling force/pole, max.                     | 9 N                                    |                   |                            |
| Tightening torque                            | Torque type                            | Wire connection   |                            |
|  | Usage information                      | Tightening torque | min. 0.4 Nm<br>max. 0.5 Nm |

**Material data**

|                                       |          |                                       |                            |
|---------------------------------------|----------|---------------------------------------|----------------------------|
| Insulating material                   | PBT      | Colour                                | orange                     |
| Colour chart (similar)                | RAL 2000 | Insulating material group             | IIIa                       |
| Comparative Tracking Index (CTI)      | ≥ 200    | Insulation strength                   | ≥ 10 <sup>8</sup> Ω        |
| UL 94 flammability rating             | V-0      | Contact material                      | Copper alloy               |
| Contact surface                       | tinned   | Layer structure of plug contact       | 4...8 μm Sn hot-dip tinned |
| Storage temperature, min.             | -40 °C   | Storage temperature, max.             | 70 °C                      |
| Operating temperature, min.           | -50 °C   | Operating temperature, max.           | 100 °C                     |
| Temperature range, installation, min. | -25 °C   | Temperature range, installation, max. | 100 °C                     |

**BLZP 5.08HC/02/180 SN OR BX**

**Weidmüller Interfaces GmbH & Co. KG**

Postfach 3030

32760 Detmold

Tel. +49 5231 14-0

Fax. +49 5231 14-2083

info@weidmueller.com

www.weidmueller.com

**Technical data**

**Conductors suitable for connection**

|   |                      |   |  |
|---|----------------------|---|--|
| Clamping range, min.                            | 0.13 mm <sup>2</sup> | Clamping range, max.                            | 1.1 mm <sup>2</sup>  |
| Wire connection cross section AWG, min.         | AWG 30               | Wire connection cross section AWG, max.         | AWG 12   |
| Solid, min. H05(07) V-U                         | 0.2 mm <sup>2</sup>  | Solid, max. H05(07) V-U                         | 4 mm <sup>2</sup>  |
| Flexible, min. H05(07) V-K                      | 0.2 mm <sup>2</sup>  | Flexible, max. H05(07) V-K                      | 4 mm <sup>2</sup>  |
| w. plastic collar ferrule, DIN 46228 pt 4, min. | 0.2 mm <sup>2</sup>  | w. plastic collar ferrule, DIN 46228 pt 4, max. | 2.5 mm <sup>2</sup>  |
| w. wire end ferrule, DIN 46228 pt 1, min.       | 0.2 mm <sup>2</sup>  | w. wire end ferrule, DIN 46228 pt 1, max.       | 4 mm <sup>2</sup>  |
| Plug gauge in accordance with EN 60999 a x b; ø |                      | Reference text                                  | The outside diameter of the plastic collar should not be larger than the pitch (P). Length of ferrules is to be chosen depending on the product and the rated voltage. |
|   | 2.8 mm x 2.4 mm      |   |  |

**Rated data acc. to IEC**

|   |                        |   |                   |
|---|------------------------|---|-------------------|
| tested acc. to standard   | IEC 60664-1, IEC 61984 | Rated current, min. number of poles (Tu=20°C)                         | 23 A              |
| Rated current, max. number of poles (Tu=20°C)                             | 18 A                   | Rated current, min. number of poles (Tu=40°C)                         | 21 A              |
| Rated current, max. number of poles (Tu=40°C)                             | 16 A                   | Rated voltage for surge voltage class / pollution degree II/2         | 400 V             |
| Rated voltage for surge voltage class / pollution degree III/2            | 320 V                  | Rated voltage for surge voltage class / pollution degree III/3        | 250 V             |
| Rated impulse voltage for surge voltage class/ pollution degree II/2      | 4 kV                   | Rated impulse voltage for surge voltage class/ pollution degree III/2 | 4 kV              |
| Rated impulse voltage for surge voltage class/ contamination degree III/3 | 4 kV                   | Short-time withstand current resistance                               | 3 x 1s with 120 A |

**Rated data acc. to CSA**

|                                   |   |                                   |  |
|-----------------------------------|---|-----------------------------------|--|
| Institute (CSA)                   |  | Certificate No. (CSA)             | 200039-1121690   |
| Rated voltage (Use group B / CSA) | 300 V   | Rated voltage (Use group C / CSA) | 50 V   |
| Rated voltage (Use group D / CSA) | 300 V   | Rated current (Use group B / CSA) | 20 A   |
| Rated current (Use group D / CSA) | 20 A  | Wire cross-section, AWG, min.     | AWG 30   |
| Wire cross-section, AWG, max.     | AWG 12  | Reference to approval values      | Specifications are maximum values, details - see approval certificate. |

**BLZP 5.08HC/02/180 SN OR BX**

Weidmüller Interfaces GmbH & Co. KG

Postfach 3030

32760 Detmold



Tel. +49 5231 14-0

Fax. +49 5231 14-2083

info@weidmueller.com

**Technical data**

**Rated data acc. to UL 1059**

|                                       |   |                                       |                     |
|---------------------------------------|---|---------------------------------------|---------------------|
| Institute (UR)                        |  | Certificate No. (UR)                  | www.weidmueller.com |
|                                       |   |                                       | E60693              |
| Institute (cURus)                     |  | Certificate No. (cURus)               |                     |
|                                       |   |                                       | E60693              |
| Rated voltage (Use group B / UL 1059) | 300 V   | Rated voltage (Use group D / UL 1059) | 300 V               |
| Rated current (Use group B / UL 1059) | 20 A  | Rated current (Use group D / UL 1059) | 10 A                |
| Wire cross-section, AWG, min.         | AWG 26  | Wire cross-section, AWG, max.         | AWG 12              |
| Reference to approval values          | Specifications are maximum values, details - see approval certificate.            |                                       |                     |

**Packing**

|           |        |            |        |
|-----------|--------|------------|--------|
| Packaging | Box    | VPE length | 30 mm  |
| VPE width | 135 mm | VPE height | 350 mm |

**Type tests**

|  |                |  |                              |
|--|----------------|--|------------------------------|
| Test: Durability of markings                 | Standard       | DIN EN 61984 section 7.3.2 / 09.02 taking pattern from DIN EN 60068-2-70 / 07.96   |                              |
|  | Test           | mark of origin, rated voltage, rated cross-section, type of material               |                              |
|  | Evaluation     | available  |                              |
|  | Test           | durability   |                              |
|  | Evaluation     | passed   |                              |
| Test: Misengagement (Non-interchangeability) | Standard       | DIN EN 60512-13-5 / 11.06, IEC 60512-13-5 / 02.06                                  |                              |
|  | Test           | 180° turned with coding elements   |                              |
|  | Evaluation     | passed   |                              |
|  | Test           | visual examination   |                              |
|  | Evaluation     | passed   |                              |
| Test: Clampable cross section                | Standard       | DIN EN 60999-1 section 7 and 9.1 / 12.00, DIN EN 60947-1 section 8.2.4.5.1 / 12.02 |                              |
|  | Conductor type | Type of conductor and conductor cross-section                                      | solid 0.2 mm <sup>2</sup>    |
|  |                | Type of conductor and conductor cross-section                                      | stranded 0.2 mm <sup>2</sup> |
|  |                | Type of conductor and conductor cross-section                                      | solid 2.5 mm <sup>2</sup>    |
|  |                | Type of conductor and conductor cross-section                                      | stranded 2.5 mm <sup>2</sup> |
|  |                | Type of conductor and conductor cross-section                                      | AWG 26/1                     |
|  |                | Type of conductor and conductor cross-section                                      | AWG 26/19                    |
|  | Evaluation     | passed   |                              |

**BLZP 5.08HC/02/180 SN OR BX**

**Weidmüller Interfaces GmbH & Co. KG**

Postfach 3030

32760 Detmold

Tel. +49 5231 14-0

**Technical data**

Fax. +49 5231 14-2083

|   |                |   |                              |  |
|---|----------------|---|------------------------------|--|
| Test for damage to and accidental loosening of conductors | Standard       | DIN EN 60999-1 section 9.4 / 12.00            |                              |  |
|   | Requirement    | 0.2 kg info@weidmueller.com                   |                              |  |
|   | Conductor type | Type of conductor and conductor cross-section | AWG 26/1                     |  |
|   |                | Type of conductor and conductor cross-section | AWG 26/19                    |  |
|   | Evaluation     | passed  |                              |  |
|   | Requirement    | 0.3 kg  |                              |  |
|   | Conductor type | Type of conductor and conductor cross-section | solid 0.5 mm <sup>2</sup>    |  |
|   |                | Type of conductor and conductor cross-section | stranded 0.5 mm <sup>2</sup> |  |
|   | Evaluation     | passed  |                              |  |
|   | Requirement    | 0.9 kg  |                              |  |
|   | Conductor type | Type of conductor and conductor cross-section | AWG 12/1                     |  |
|   |                | Type of conductor and conductor cross-section | AWG 12/19                    |  |
| Evaluation  | passed         |   |                              |  |
| Pull-out test   | Standard       | DIN EN 60999-1 section 9.5 / 12.00            |                              |  |
|   | Requirement    | ≥10 N   |                              |  |
|   | Conductor type | Type of conductor and conductor cross-section | AWG 26/1                     |  |
|   |                | Type of conductor and conductor cross-section | AWG 26/19                    |  |
|   | Evaluation     | passed  |                              |  |
|   | Requirement    | ≥20 N   |                              |  |
|   | Conductor type | Type of conductor and conductor cross-section | H05V-U0.5                    |  |
|   |                | Type of conductor and conductor cross-section | H05V-K0.5                    |  |
|   | Evaluation     | passed  |                              |  |
|   | Requirement    | ≥60 N   |                              |  |
|   | Conductor type | Type of conductor and conductor cross-section | H07V-U4.0                    |  |
|   |                | Type of conductor and conductor cross-section | H07V-K4.0                    |  |
| Type of conductor and conductor cross-section             |                | AWG 12/1                                      |                              |  |
| Type of conductor and conductor cross-section             |                | AWG 12/19                                     |                              |  |
| Evaluation  | passed         |   |                              |  |

**BLZP 5.08HC/02/180 SN OR BX**

Weidmüller Interfaces GmbH &amp; Co. KG

Postfach 3030

32760 Detmold

Tel. +49 5231 14-0

Fax. +49 5231 14-2083

[info@weidmueller.com](mailto:info@weidmueller.com)[www.weidmueller.com](http://www.weidmueller.com) EC002638

eClass 9.1 27-44-03-09

eClass 11.0 27460202

**Technical data****Classifications**

|             |             |             |                              |
|-------------|-------------|-------------|------------------------------|
| ETIM 6.0    | EC002638    | ETIM 7.0    | www.weidmueller.com EC002638 |
| eClass 9.0  | 27-44-03-09 | eClass 9.1  | 27-44-03-09                  |
| eClass 10.0 | 27-44-03-09 | eClass 11.0 | 27460202                     |

**Important note**

IPC conformity Conformity: The products are developed, manufactured and delivered according international recognized standards and norms and comply with the assured properties in the data sheet resp. fulfill decorative properties in accordance with IPC-A-610 "Class 2". Further claims on the products can be evaluated on request.

**Approvals**

Approvals



ROHS Conform

UL File Number Search E60693

**Downloads**

|   |  |
|---|--|
| Approval/Certificate/Document of Conformity | <a href="#">CB Certificate</a><br><a href="#">CB Testreport</a><br><a href="#">Declaration of the Manufacturer</a>   |
| Brochure/Catalogue                          | <a href="#">FL DRIVES EN</a><br><a href="#">MB DEVICE MANUF. EN</a><br><a href="#">FL DRIVES DE</a><br><a href="#">CAT 2 PORTFOLIOGUIDE EN</a><br><a href="#">FL BUILDING SAFETY EN</a><br><a href="#">FL APPL LED LIGHTING EN</a><br><a href="#">FLIndustr.CONTROLS EN</a><br><a href="#">FL MACHINE SAFETY EN</a><br><a href="#">FL HEATING ELECTR EN</a><br><a href="#">FL APPL INVERTER EN</a><br><a href="#">FL_BASE_STATION EN</a><br><a href="#">FL ELEVATOR EN</a><br><a href="#">FL POWER SUPPLY EN</a><br><a href="#">FL 72H SAMPLE SER EN</a><br><a href="#">PO OMNIMATE EN</a> |
| Engineering Data                            | <a href="#">STEP</a>   |
| Engineering Data                            | <a href="#">EPLAN, WSCAD, Zuken E3.S</a>   |

**Data sheet**

**BLZP 5.08HC/02/180 SN OR BX**

**Weidmüller Interfaces GmbH & Co. KG**

Postfach 3030

32760 Detmold

Tel. +49 5231 14-0

Fax. +49 5231 14-2083

**Drawings**

**Dimensional drawing** [info@weidmueller.com](mailto:info@weidmueller.com)

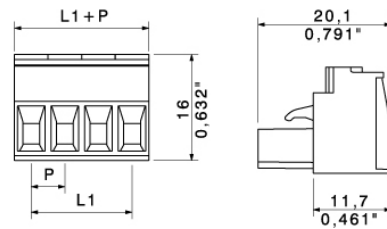

**Graph**

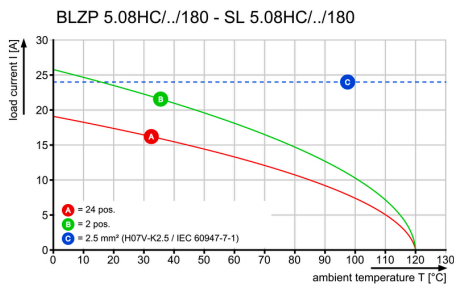

**Graph**

